

Product Installation Guidelines

Version 1.1, 14 April 2023, Page 1 of 3

Ezy-Push® 316SS Lead Safe™ Timeflow Push Button Replacement Cartridge 6 Sec

PRODUCT CODES:

- 368916X

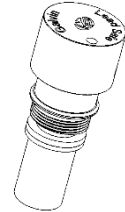

SPECIFICATIONS

- The Timeflow Push Button Cartridge is suitable for Ezy-Push® 316SS Lead Safe Timeflow taps only.
- Our range of AS/NZS 3718 approved Ezy-Push® Push Button tapware is reliable and durable.
- Constructed from Stainless Steel Ezy-Push® Push Button tapware delivers a constant flow irrespective of pressure to provide a controlled stream.
- It is designed to suit the increasing need for conservation of water and minimisation of vandalism.
- The cartridges are made of Lead Safe* Stainless Steel.

* As 'lead free' is not currently defined by law in Australia and New Zealand, we have based our definition of Lead Safe™ on the requirements of Sec. 1417 of the USA's Safe Drinking Water Act (SDWA) and the relevant US standards NSF61 / NSF372. The SDWA defines 'lead free' as "not more than a weighted average of 0.25% lead when used with respect to the wetted surface of pipes, pipe fittings, plumbing fittings and fixtures".

IMPORTANT: All Ezy-Push® Time Flow Pillar Taps are tested in accordance with AS/NZS 3718 and leave our premises in good working order. Time may vary due to changes in temperature, pressure, flow rate and water quantity.

TECHNICAL DATA

Assembly Thread		M26 x19 TPI - Male
Outlet		N/A
Headwork		Time Flow Cartridge
Working Pressure Range (kPa)	Min	200
	Max	500
Working Temperature (°C)	Min	5
	Max	65
Nominal Flow Rate (LPM)		N/A
Construction		Stainless Steel
Finish		Brushed

NOTE: Galvin Engineering continually strive to improve their products. Specifications may change without notice.

TOOLS REQUIRED

- 24mm Spanner

INSTALLATION

IMPORTANT: Galvin Specialised products must be installed in accordance with these installation instructions and in accordance with AS/NZS 3500, the PCA and your local regulatory requirements. Water and/or electrical supply conditions must also comply to the applicable national and/or state standards. Failing to comply with these provisions shall void the product warranty and may affect the performance of the product.

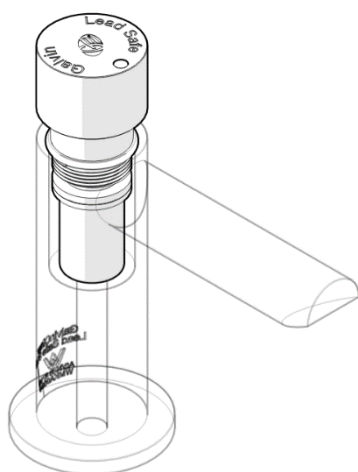

1. Turn off water supply

- Prior installation, turn off water supply.

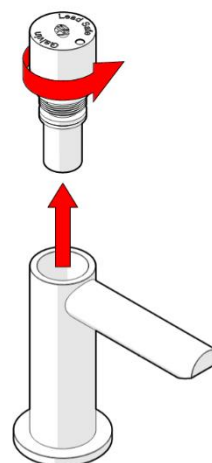

2. Remove Timeflow Cartridge

- Unscrew the timeflow cartridge using a 24mm spanner.

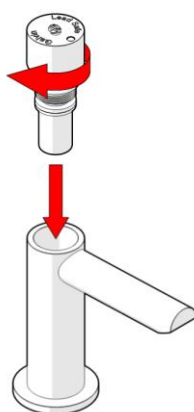

3. Replace Timeflow Cartridge

- Fit the new timeflow cartridge using a 24 mm spanner.

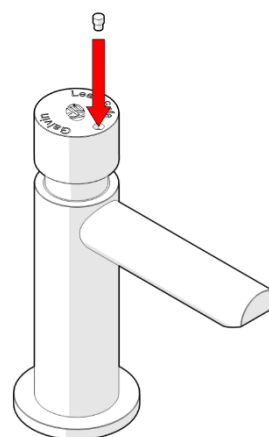

4. Place indicator and inspect

- Fit color indicator hot (red), cold (blue) or warm (yellow) as required on the cap.
- When installation is complete, slowly open water supply and inspect for leaks.
- Check for correct operation.

TROUBLESHOOTING

PROBLEM	CAUSE	RECTIFICATION
Taps are dripping water	Dirt/Debris in cartridge	Remove and clean cartridge
	Faulty cartridge	Replace cartridge
Water is not flowing from tap	Water is turned off	Turn on water
	Aerator or flow regulator is blocked by debris	Remove aerator and/or flow regulator from tap and remove debris. Install an inline strainer.

WARRANTY

The warranty set forth herein is given expressly and is the only warranty given by the Galvin Engineering Pty Ltd. With respect to the product, Galvin Engineering Pty Ltd makes no other warranties, express or implied. Galvin Engineering Pty. Ltd. hereby specifically disclaims all other warranties, express or implied, including but not limited to the implied warranties of merchantability and fitness for a particular purpose.

Galvin Engineering Pty Ltd products are covered under our manufacturer's warranty available for download from www.galvinengineering.com.au. Galvin Engineering Pty Ltd expressly warrants that the product is free from operational defects in workmanship and materials for the warranty period as shown on the schedule in the manufacturer's warranty. During the warranty period, Galvin Engineering will replace or repair any defective products manufactured by Galvin Engineering without charge, so long as the terms of the Manufacturer's warranty are complied with.

The remedy described in the first paragraph of this warranty shall constitute the sole and exclusive remedy for breach of warranty, and Galvin Engineering Pty Ltd shall not be responsible for any incidental, special or consequential damages, including without limitation, lost profits or the cost of repairing or replacing other property which is damaged if this product does not work properly, other costs resulting from labour charges, delays, vandalism, negligence, fouling caused by foreign material, damage from adverse water conditions, chemical, electrical or any other circumstances over which Galvin Engineering has no control. This warranty shall be invalidated by any abuse, misuse, misapplication, improper installation or improper maintenance or alteration of the product.

Within Australia: 1300 514 074 Outside Australia: P: +61 (0)8 9338 2344

F: +61 (0)8 9338 2340

sales@galvinengineering.com.au

www.galvinengineering.com.au

ABN: 78 008 719 382

PERTH | SYDNEY | MELBOURNE | BRISBANE | ADELAIDE

